

# C-PUMA<sup>INT</sup> Installation instructions

## Standard configuration

Control box	1
Motor cord	1
Seal ring	3
Axial plug pump	1
Control cord	1
Power cord	1
T-junction	1
Installation instructions	1
Identifying label	1
1 : 1 optic fiber inner channel handpiece(optional)	1
1 : 5 optic fiber handpiece(optional)	1

## Technical parameters

1. Power :	150W
2. Control box, input voltage:	AC 24V
3. Range of speed:	2,000 - 40,000 rpm
4. Torque output :	2.0 N.cm
5. Environment temperatures :	-10~+55℃
6. Humidity :	20~80% RH
7. Atmospheric pressure:	86~106kPa
8. Protection against electrical shock:	Type B

## Installation

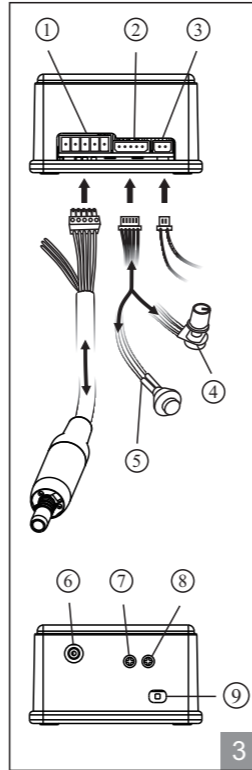
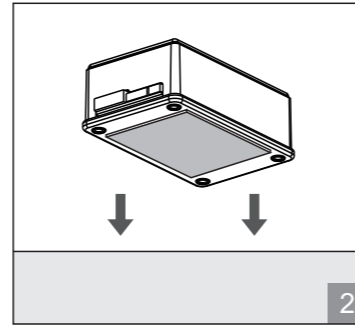
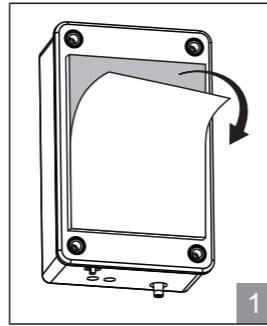

- ① Motor port
- ② Control cord port
- ③ Power cord port
- ④ Adjust the rotate speed of motor(Adjusting Range: 2000-40000rpm)
- ⑤ Switch the rotate direction of motor
- ⑥ Pneumatic pressure control detection port
- ⑦ Brightness adjust
- ⑧ Light delay turn-off time adjust  
(Adjusting Range:0-5S)
- ⑨ Starting mode switch (the switch pull left to choose pneumatic, pull right to choose electric)

1. Use the gum stick on the bottom of control box, to fixed control box inside the tool shelf of dental chair. (As shown in figure 1 and figure 2)
2. Connect wiring on the corresponding port of the control box. (As shown in figure 3)
3. The function part of the motor cord and control line are fixed outside the tool shelf of dental chair.

## ⚠ Notice

1. In pneumatic mode, when ⑥ detected the input pressure, and ④ is more than zero, the motor will start; in electric mode, when ④ is more than zero, the motor will start.
2. The formal work way for system uses pneumatic control, electric methods generally use only for debugging or testing purposes.
3. If you want to use dental chair inside power supply for the unit, please ensure that the output power of dental chair is more than 250 w.

## Cleaning and sterilization

High temperature and high pressure sterilization is recommended. Every time after treatment, please follow the following methods to start the high temperature and high pressure sterilization. Only the motor part is available under the high temperature and high pressure sterilization.

### ⚠ Note:

Apart from the parts that are available under the high temperature and high pressure sterilization, the other (main unit, power cord), please do not put into high temperature and high pressure sterilization.

1. Please use the brush (not metal brush) to clean the attached dirt on the motor surface.
2. Please do not oil the motor. Install the axial plug pump to the motor.
3. Put into the bag and seal for the high temperature and high pressure sterilization.
4. Use the temperature which is not more than 135 °C to sterilize.

(such as: 121 °C 20min, or 134 °C 15min).

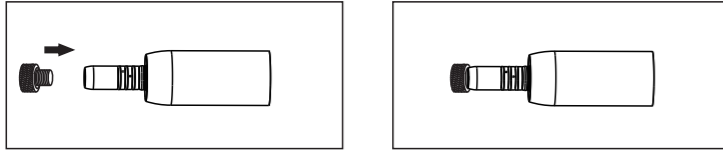

#### Attention for High temperature and high pressure sterilization

1. Screw the Motor Cap to the Motor and the protection plug to the Motor connection.

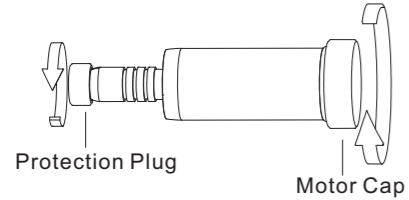

#### After sales

The main unit is guaranteed for 12 months from the date of purchase.

The guarantee is valid for normal usage conditions. Any modification or accidental damage will render the guarantee void.

## Dental Brushless Electric Motor(built-in) installation diagram

